

ALUMINUM

PART NO.	A	B	C	WT.
AS-18AL	18"	12"	36"	132
AS-23AL	23"	12"	36"	152
AS-2317AL	23"	17"	36"	175
AS-35AL	35"	12"	36"	204
AS-25AL	25"	13"	41"	155
AS-25MAL	25"	13"	41"	175

- .125 Aluminum
- 5052 Type Aluminum
- Aluminum hinge (full length)
- Vandal & weather resistant enclosure
NEMA 3R rainproof enclosure as listed
by Underwriters Laboratories, Inc.
- Pry resistant 1" flanged doors.
- Front door louvers with rain-guard shield.
- Neoprene weather striping (full door)
3/4" plywood or aluminum backboard
mounted with 4 aluminum bolts.
- Internal document tray inside door.
- Steel fabricated "Universal Mounting
Base" with aluminum hardware.
- Limited warranty 10 years

Locking device options, stainless & mild steel

- single, dual or 3 point locking systems
- Key type handles
- Padlock mechanisms
- Combination style locks
- Slam latch & more

Optional Finishes

- Powder coating - optional
- Painting - optional

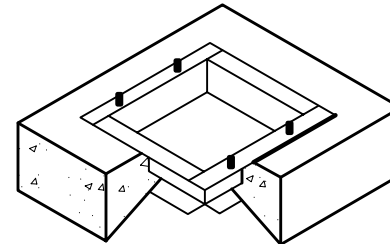
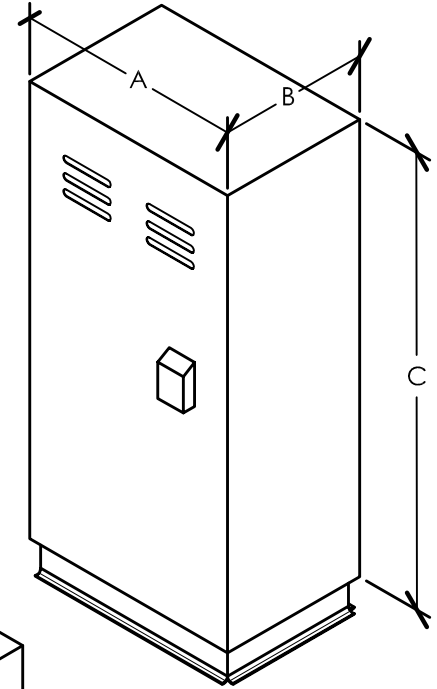

POUR IN PLACE WITH CUTAWAY
UNIVERSAL MOUNTING BASE

PLOT DATE: 06-20-06