

## STAINLESS STEEL

PART NO.	A	B	C	WT.
AS-18SS	18"	12"	36"	83
AS-23SS	23"	12"	36"	94
AS-2317SS	23"	17"	36"	112
AS-25SS	25"	13"	41"	98
AS-35SS	35"	11"	36"	132

- 12 gauge stainless steel type 304 non magnetic, with #4 finish.
- Stainless steel hinge and pin (staked).
- Vandal & weather resistant enclosure NEMA 3R rainproof enclosure as listed by Underwriters Laboratories, Inc.
- Pry resistant 1" flanged doors.
- Front door louvers with rain-guard shield.
- Neoprene weather striping (full door)
- 3/4" plywood or stainless steel backboard mounted with 4 stainless steel bolts.
- Internal document tray inside door.
- Stainless steel fabricated "Universal Mounting Base" and hardware.
- Limited warranty 15 years

### Locking device options, stainless & mild steel

- single, dual or 3 point locking systems
- Key type handles
- Padlock mechanisms
- Combination style locks
- Slam latch & more

### Optional Finishes

- Painting - optional

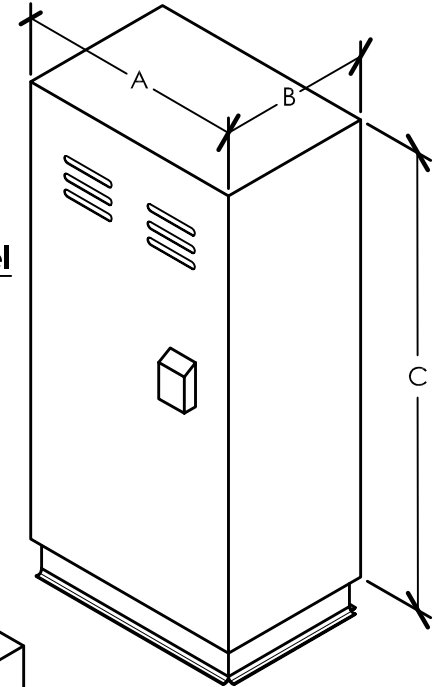
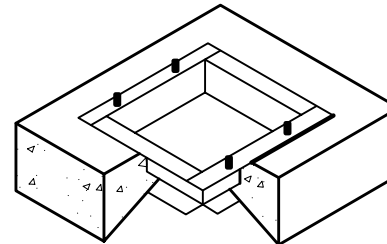

POUR IN PLACE WITH CUTAWAY  
UNIVERSAL MOUNTING BASE